

Waste Management Plan

**16-Stapleton Parade
St MARYS**

September 2024

1.0 GENERAL

This document comprises a Waste Management Plan for the proposed development at 16-18 Stapleton Parade. It describes three stages of waste management: Demolition, Construction and Operation.

1.1 Description of development

The subject site is within the Penrith City Council local government area. The proposed is multi-unit residential development consisting of 18 dwellings (8 x 1bed + 10 x 2bed). All 18 units are connected to the ground floor via lift and common stairs.

2.0 DEMOLITION WASTE

2.1 General

The proposal includes excavation for basement carpark and to level the floor plate and for accessibility. Most excavation waste material will be transported from the site to recycling or landfill depots off-site.

2.2 Off-site recycling & disposal

Details of the Waste & Recycling depots are described in the WMP template and listed here below:

Penrith Landfill Depot 842 Mulga Road Mulgoa, NSW, 2745
Ph 02 4733 8778

3.0 CONSTRUCTION WASTE

3.1 General

The proposal is designed to minimize waste generation throughout the construction process. Our Construction Management Plan will be implemented to ensure that waste generation is kept to a minimum. This includes implementing recycling programs, promoting materials reuse, and adopting efficient packaging practices.

4.0 OPERATIONAL WASTE

4.1 General

The proposed development comprises a clear waste management system, ensuring ease of usability to the residents and compliance with the Penrith City Council's DCP outlined in Chapter C5, Waste Management.

4.2 Description of waste storage areas

The bin storage for residents is located within the front setback and accessed directly from the main entry with an easy transition for collection. The following waste bins are provided:

Stapleton Parade Entry:

4 x 240L bins for general garbage
4 x 240L bins for recycling
Total: 8 waste bins

Lethbridge Street Entry:

5 x 240L bins for general garbage
5 x 240L bins for recycling
Total: 10 waste bins

Both waste storage area contain a tap and hose and is to be connected to the sewer.

4.3 Waste management strategy

The residents in the apartments will utilize the common garbage storage for all general garbage, including this waste's recyclable components.

The collection is to be incorporated into the Council's existing weekly/fortnightly collection operations.

Refer to Figure 1 below for diagrams outlining operations and paths of travel.

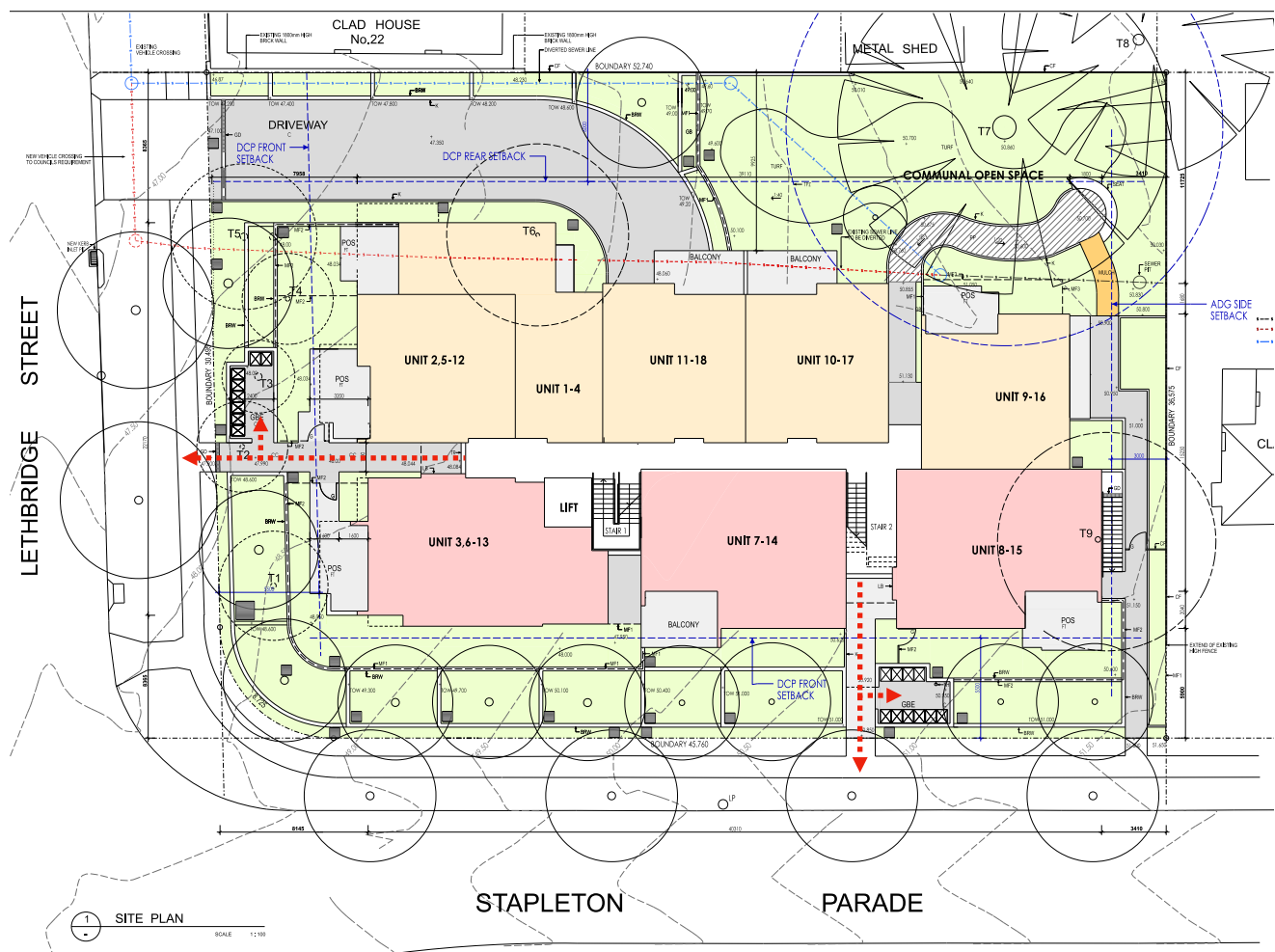

Figure 1 - Garbage Bin Facilities

WASTE MANAGEMENT PLAN

Demolition, construction and ongoing management

Site details					
Site address:	16-18 Stapleton Parade				
Suburb:	St. Marys				
Postcode:	2760				

Applicants details					
Name:	Homes				
Address:					
Suburb:					
Postcode:					
Telephone:					
Mobile:					
Email:					

☒ The details provided on this form are for the intention of managing waste relating to this project.

General demolition waste					
Type of material	Amount		How will you manage this waste		
	Less than 10m³	More than 10m³	Reuse on-site	Recycle	Landfill
Bricks					
Concrete	✓			✓	
Tiles					
Timber (clean)					
Timber (treated)					
Asphalt					
Metals	✓			✓	
Plasterboard					
Green waste		✓		✓	
Other - specify					
Other - specify					
Principal Off-Site Recyclers: TBA					
Principal Licensed Landfill Sites: TBA					

CONSTRUCTION

Will a skip bin hire company be used?

☒ Yes for some work ☐ Yes for all work ☐ No

Estimated total volume of waste: 80m³

Name of skip bin hire company used: TBA

Address:

Suburb:

Postcode:

ABN Number:

Contractor License Number:

Tick ☐ if a skip bin hire company has not been appointed. If approved, a condition of consent may be placed on the Development Application requiring the above details prior to works commencing on-site.

If using a skip bin hire company for all work, please stop here.

All excavation material including swimming pools

☐ Less than 10m³ ☐ More than 10m³

☐ Reuse on-site ☐ Reuse off-site ☐ Landfill disposal

Address if reused off-site: TBA

Name of licensed landfill: TBA

Address of licensed landfill: TBA

Type of material	Amount		How will you manage this waste		
	Less than 10m ³	More than 10m ³	Reuse on-site	Recycle	Landfill
Bricks	<input checked="" type="checkbox"/>	<input type="checkbox"/>	<input type="checkbox"/>	<input checked="" type="checkbox"/>	<input type="checkbox"/>
Concrete	<input checked="" type="checkbox"/>	<input type="checkbox"/>	<input type="checkbox"/>	<input checked="" type="checkbox"/>	<input type="checkbox"/>
Tiles	<input checked="" type="checkbox"/>	<input type="checkbox"/>	<input type="checkbox"/>	<input checked="" type="checkbox"/>	<input type="checkbox"/>
Timber (clean)	<input checked="" type="checkbox"/>	<input type="checkbox"/>	<input checked="" type="checkbox"/>	<input type="checkbox"/>	<input type="checkbox"/>
Timber (treated)	<input type="checkbox"/>	<input type="checkbox"/>	<input type="checkbox"/>	<input checked="" type="checkbox"/>	<input type="checkbox"/>
Asphalt	<input checked="" type="checkbox"/>	<input type="checkbox"/>	<input type="checkbox"/>	<input checked="" type="checkbox"/>	<input type="checkbox"/>
Metals	<input checked="" type="checkbox"/>	<input type="checkbox"/>	<input type="checkbox"/>	<input checked="" type="checkbox"/>	<input type="checkbox"/>
Plasterboard	<input checked="" type="checkbox"/>	<input type="checkbox"/>	<input type="checkbox"/>	<input checked="" type="checkbox"/>	<input type="checkbox"/>
Green waste	<input checked="" type="checkbox"/>	<input type="checkbox"/>	<input type="checkbox"/>	<input checked="" type="checkbox"/>	<input type="checkbox"/>
Other - specify	<input type="checkbox"/>	<input type="checkbox"/>	<input type="checkbox"/>	<input type="checkbox"/>	<input type="checkbox"/>
Other - specify	<input type="checkbox"/>	<input type="checkbox"/>	<input type="checkbox"/>	<input type="checkbox"/>	<input type="checkbox"/>

Principal Off-Site Recyclers: TBA

Principal Licensed Landfill Sites: TBA

ONGOING MANAGEMENT

- ☒
- Multi dwelling housing with individual bin storage areas
-
- ☒
- Multi dwelling housing with communal bin storage area
-
- ☐
- Mixed use development
-
- ☐
- Commercial/retail or Industrial development

Proposed number of residential dwellings: 18

Proposed number of commercial dwellings: none

Bin size and collection frequency

Council allocates bins at the rates prescribed in Section 3.2 of the Waste Management Guide. Standard bin dimensions are detailed in Section 3.3 of the Guide.

Service	Bin Size	Number of bins required	Standard collection frequency	Approved alternate collection frequency*
Garbage	<input checked="" type="radio"/> 240L	9 x 240L	Weekly	Weekly ▼
	<input type="radio"/> 660L			
	<input type="radio"/> 1100L			
Recycling	<input checked="" type="radio"/> 240L	9 x 240L	Fortnightly	Weekly ▼
	<input type="radio"/> 660L			
	<input type="radio"/> 1100L			